

R020SN SERIES

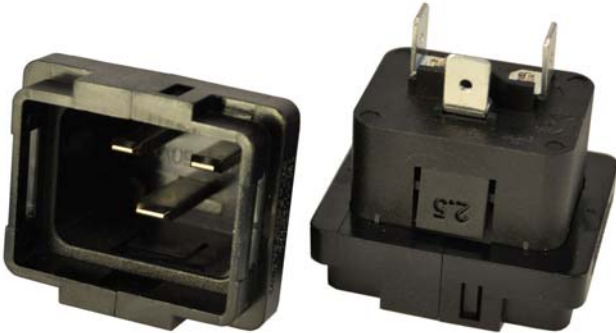

US Patent



SPECIFICATION	DISCRIPTION
Standard	IEC 60320 C20
Insulation Resistance	Over 100MΩ at 500V DC
Dielectric Strength	2000V AC 1 Minute
Material	Thermoplastic 94V-2~V-0
MAX Operating Temperature	≤105°C
Locking Feature	Mate with SSEMCO Locking C19
Rating	20A 250V AC (UL)
	16A 250V AC (EUROPEAN)

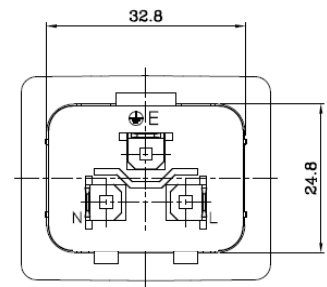
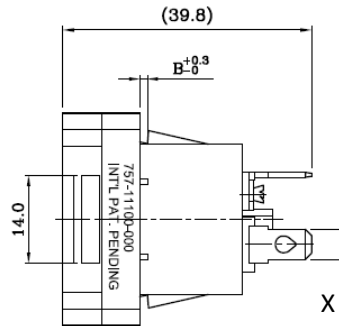
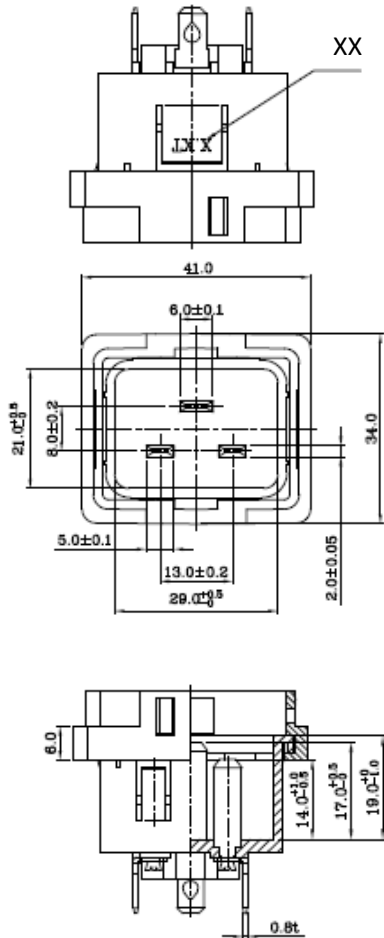

PANEL THICKNESS	
XX	B
10	1.0mm
12	1.2mm
15	1.5mm
20	2.0mm

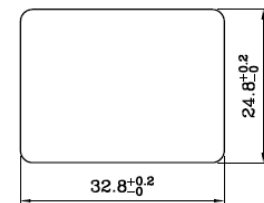

PANEL CUT-OUT

ORDERING INFORMATION

Unit : mm

<u>R020SN</u>	<u>-XX</u>	<u>5</u>	<u>3</u>	<u>6</u>	<u>Y</u>
IEC C20	PANEL THICKNESS	1:GRAY	2:BLUE	NUMBER	TAB WIDTH
SANP IN	10: 1.0mm	5:BLACK	7:RED	OF TABS	4:4.0mm
INLET	12: 1.2mm	9:WHITE			5:4.8mm
	15: 1.5mm				6:6.3mm
	20: 2.0mm				
					0: 1.8mm HOLE
					1: 2.8mm HOLE